



Reykjanesbær

Evacuation due to volcanic eruption, large earthquakes, or other alerts from the Department of Civil Protection and Emergency Management

Escape routes out of town:



Escape routes within the town:

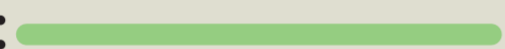

- Keflavík
- Keflavík
- Keflavík
- Ytri Njarðvík
- Ytri Njarðvík
- Ytri Njarðvík
- Innri Njarðvík
- Innri Njarðvík
- Ásbrú

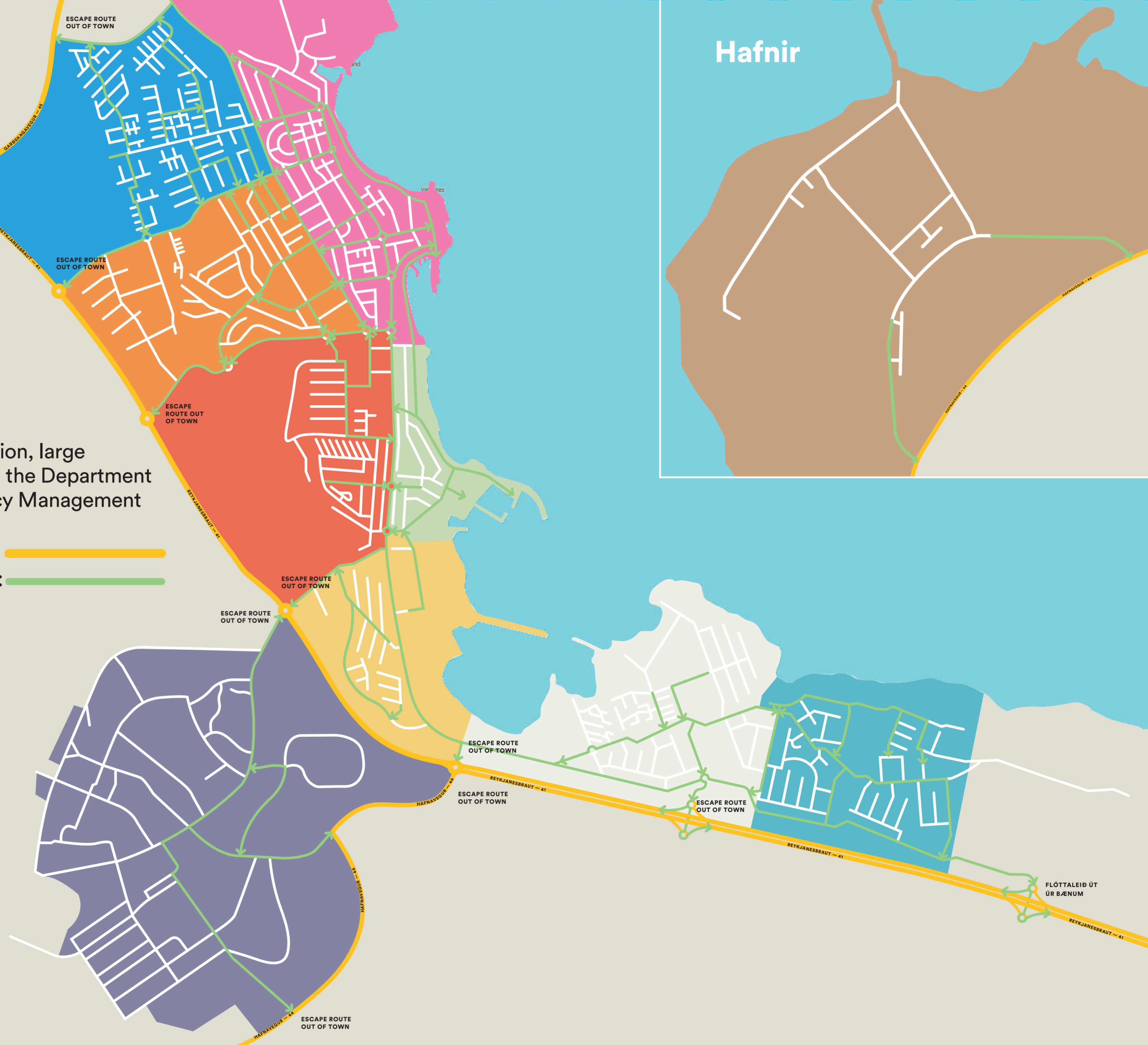



Instructions for evacuation

Evacuation is part of The Civil Protection's mitigation measures to reduce the impact of danger on society and its inhabitants, before an emergency situation arises or for the duration of an emergency situation. That includes residents moving to a safe location and then returning safely home after the emergency situation is over. To ensure that evacuation goes well, it is important that a plan for the implementation of evacuation be in place.

Indications of an impending volcanic eruption are widely felt earthquakes and disturbances on meters at scientific institutions. Scientists inform Civil Protection that an eruption is about to take place, and Civil Protection activates its arrangements and plans.

Due to the level of uncertainty, it is important that the residents of Reykjanesbær familiarize themselves with the following information.

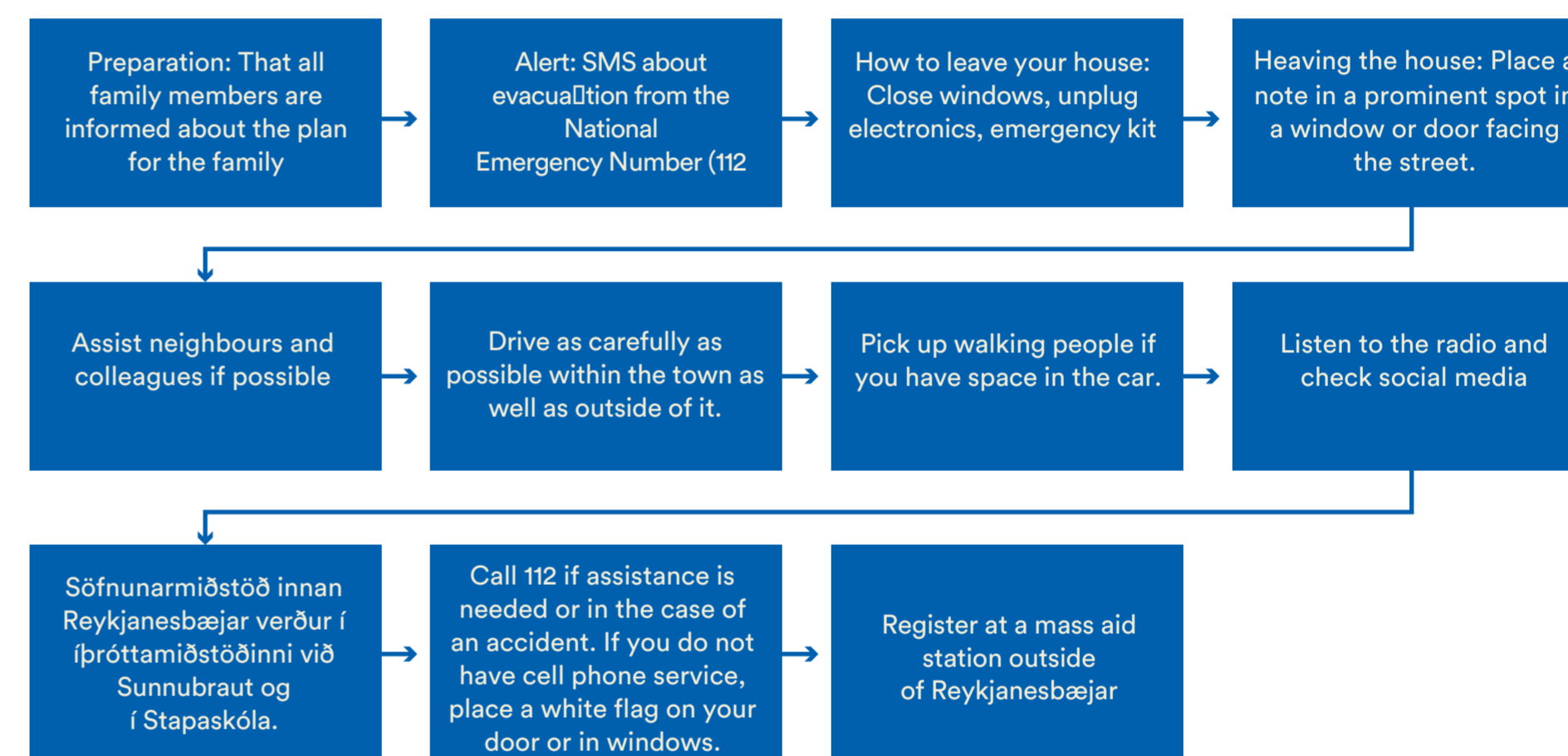

- Picking up family members in different parts of town
 - Children in kindergarten and primary school should be picked up by a parent or a guardian. It is important that parents know if their children are outside of the class-room (sports, swimming, etc.) during school hours
 - Each institution should have its own evacuation plan that parents should familiarize themselves with.
 - It is important that you familiarize yourself with traffic plans that go into effect in Reykjanesbær during an evacuation.
 - Parents are encouraged to pick up their children on foot if possible.
- It is not mandatory to go to the gathering place at the sports centre on Sunnubraut or in Stapaskóli, it is primarily meant for those who need assistance leaving town.
- General information can be obtained through the Red Cross helpline: 1717
- Attention: If the chief of police issues instructions to evacuate, residents are required to evacuate their homes.
- More detailed information can be found on the website of the Department of Civil Protection and Emergency Management, www.almannavarnir.is

Mass aid stations

Reykjanesbær: Íþróttarhúsið við Sunnubraut, Stapaskóli
 Suðurnesjabær: Grunnskólinn Garði, Grunnskólinn Sandgerði
 Grindavík: Hópsskóli
 Kópavogur: Kórinn

Assistance and information

Need for assistance:
 Emergency line: 112
 Need for information:
 Red Cross helpline: 1717





Reykjanesbær – Keflavík

Evacuation due to volcanic eruption, large earthquakes, or other alerts from the Department of Civil Protection and Emergency Management

Escape routes out of town:

Escape routes within the town:

One-way traffic:

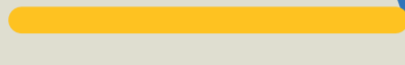

- 1 HEIÐARSKÓLI
- 2 LEIKSKÓLINN GARÐAS
- 3 LEIKSKÓLINN HEIÐARSEL
- 4 FJÖLBRAUTASKÓLI SUÐURNESJA
- 5 KNATTSPYRNUMSVÆÐI KEFLAVÍKUR
- 6 BARDAGAHÖLL REYKJANESBÆJAR
- 7 ÍPRÓTTAMIÐSTÖÐ VIÐ SUNNUBRAUT | SÖFNUNARMIÐSTÖÐ
- 8 SUNDMIÐSTÖÐ SUNNUBRAUT
- 9 LÖGREGLUSTÖÐ
- 10 SLÖKKVISTÖÐ
- 11 NETTÓ
- 12 RAUÐI KROSSINN
- 13 HRAFNI STA HLÉVANGUR
- 14 MYLLUBAKKASKÓLI
- 15 KEFLAVÍKURHÖFN
- 16 KEFLAVÍKURKIRKJA
- 17 LEIKSKÓLINN VESTURBERG
- 18 LEIKSKÓLINN TJARNARSEL
- 19 HOLTASKÓLI
- 20 RÁÐHÚS REYKJANESBÆJAR
- 21 SAFNAÐARHEIMILI KEFLAVÍKURKIRKJU
- 22 HEILBRIGÐISSTOFNUN SUÐURNESJA
- 23 KRAMBÚÐ
- 24 VERSLUNARKJARNI KROSSMÓA

ESCAPE ROUTE OUT OF TOWN

ESCAPE ROUTE OUT OF TOWN





ESCAPE ROUTE OUT OF TOWN

Reykjanesbær – Ytri Njarðvík

Evacuation due to volcanic eruption, large earthquakes, or other alerts from the Department of Civil Protection and Emergency Management

Escape routes within the town:

- 25 BJÖRGUNARVEITIN SUÐURNES
- 26 NESVELLIR
- 27 REYKJANESHÖLLIN
- 28 KNATTSPYRNUSVÆÐI NJARÐVÍKUR
- 29 FIMLEIKAHÚS
- 30 LEIKSKÓLINN HJALLATÚN
- 31 LEIKSKÓLINN GIMLI
- 32 VERSLUNIN KOSTUR
- 33 TÓNLISTARSKÓLI REYKJANESBÆJAR | HLJÓMAHÖLL
- 34 VERSLUNARKJARNI KROSSMÓA
- 35 NJARÐVÍKURSKÓLI - ÖSPIN
- 36 NJARÐVÍKURSKÓLI
- 37 NJARÐVÍKURHÖFN
- 38 ÍÞRÓTTAMIÐSTÖÐ NJARÐVÍKUR
- 39 YTRI-NJARÐVÍKURKIRKJA

ESCAPE ROUTE OUT OF TOWN





ESCAPE ROUTE OUT OF TOWN

ESCAPE ROUTE OUT OF TOWN

Reykjanesbær – Ytri Njarðvík

Evacuation due to volcanic eruption, large earthquakes, or other alerts from the Department of Civil Protection and Emergency Management

Escape routes out of town: 
Escape routes within the town: 



Reykjanesbær – Innri Njarðvík (Tjarnahverfi)

Evacuation due to volcanic eruption, large earthquakes, or other alerts from the Department of Civil Protection and Emergency Management

Escape routes out of town:



Escape routes within the town:



ESCAPE ROUTE OUT OF TOWN



ESCAPE ROUTE OUT OF TOWN



- 43** AKURSKÓLI
- 44** NJARÐVÍKURKIRKJA
- 45** LEIKSKÓLINN AKUR
- 46** LEIKSKÓLINN HOLT
- 47** SAFNAÐARHEIMILI VIÐ INNRI-NJARÐVÍKURKIRKJU
- 48** KRAMBÚÐ





Reykjanesbær – Innri Njarðvík (Dalshverfi)

Evacuation due to volcanic eruption, large earthquakes, or other alerts from the Department of Civil Protection and Emergency Management

Escape routes out of town: 
Escape routes within the town: 

49 STAPASKÓLI | SÖFNUNARMIÐSTÖÐ

50 LEIKSKÓLI VIÐ STAPASKÓLA

ESCAPE ROUTE OUT OF TOWN





Reykjanesbær – Ásbrú

Evacuation due to volcanic eruption, large earthquakes, or other alerts from the Department of Civil Protection and Emergency Management

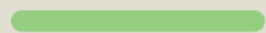
Escape routes out of town: 
Escape routes within the town: 





- 51** KEILIR
- 52** HÁALEITISSKÓLI
- 53** HÆFINGARSTÖÐ
- 54** SPORTHÚSIÐ
- 55** ST. JOHN PAUL II PARISH | KAPÓLSKA KIRKJAN Á ÍSLANDI
- 56** LEIKSKÓLINN VÖLLUR
- 57** LEIKSKÓLINN SKÓGARÁS
- 58** HJÁLPRÆÐISHERINN



Reykjanesbær – Hafnir

Evacuation due to volcanic eruption, large earthquakes, or other alerts from the Department of Civil Protection and Emergency Management

Escape routes out of town: 
Escape routes within the town: 

 KIRKJUVOGSKIRKJA

 SAFNAÐARHEIMILIÐ HÖFNUM

